

Access Control Composite

Riser/Plenum

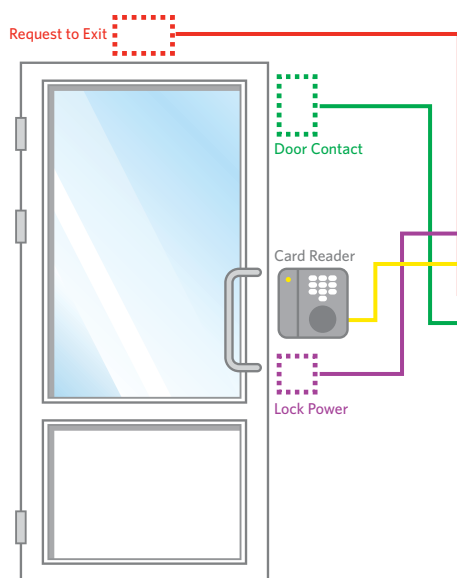
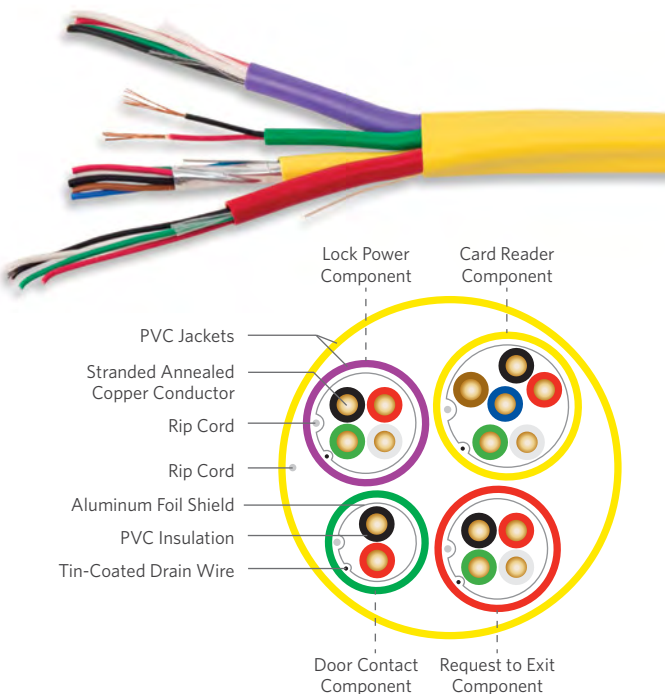

COMPONENT SPECIFICATIONS

| | |
|---------------------------|---|
| Conductor/Pair Count | Available with 2 through 4 conductors and available with 3 twisted pairs |
| Conductor | Fully annealed, stranded bare copper |
| AWG (mm) | Available in 18 (1.16) and 22 (0.64) |
| Insulation | Low smoke PVC |
| Shield (where applicable) | 1-mil overall aluminum polyester foil shield with 24 AWG (0.51 mm) solid tinned copper drain wire |
| Component Jacket | Riser: Flame Retardant (FR) PVC Plenum: Low smoke PVC |
| Component Jacket Marking | Example: LOCK POWER DOOR / ZONE A B C D E / 0 1 2 3 4 5 6 7 8 9 18 AWG/4C PLENUM |

PRODUCT DESCRIPTION

The Access Control Composite series combines four components that are required for card reader/keypad, door contact, request to exit and lock power device connectivity in a single cable. These composites are offered with an option to shield all components or just the single card reader component. Both riser and plenum jacket constructions are available.

APPLICATIONS

- Access control

FEATURES

- Four components in a single jacket
- Twisted pair in card reader component
- Jacket rip cord
- Overall shield (where applicable)
- QuickCount® marking system in feet and meters

BENEFITS

- Save labor costs with a one cable run
- Satisfies requirements of RS-232 and RS-485 protocols
- Easy to open; saves cable preparation time
- Electromagnetic Interference (EMI) protection
- Provides remaining length of cable on spool resulting in less scrap

COMPONENT COLOR CODING AND APPLICATION

| Component Number | Cable Type | Application | Component Jacket Color |
|------------------|--------------------------|-----------------|------------------------|
| 1 | 18 AWG x 4 conductors | Lock Power | Purple |
| 2 | 22 AWG x 3 twisted pairs | Card Reader | Yellow |
| 3 | 22 AWG x 4 conductors | Request to Exit | Red |
| 4 | 22 AWG x 2 conductors | Door Contact | Green |

ENVIRONMENTAL SPECIFICATIONS

| | |
|--------------|---------------------------------|
| Operation | -4°F to +167°F (-20°C to +75°C) |
| Installation | +32°F to +149°F (0°C to +65°C) |

COMPOSITE SPECIFICATIONS

| | |
|------------------------|---|
| Outer Jacket | Riser: Flame Retardant (FR) PVC Plenum: Low smoke PVC |
| Jacket Marking | Example: XXXX FT/XXXX M SUPERIOR ESSEX ACCESS CONTROL CABLE DOOR / ZONE A B C D E / 0 1 2 3 4 5 6 7 8 9 18/4C + 22/3PR SHLD + 22/4C + 22/2C (UL) CMR/ CL3R OR c(UL) CMR 75°C "ROHS COMPLIANT" |
| Package | Wood reel |
| Performance Compliance | NEC Article 725 NEC Article 800 NEC Article 760 UL® 13 CL3R/CL3P UL 444 CMR/CMP UL 1424 FPLR/FPLP UL 1666 NFPA 262 California State Fire Marshall RoHS-compliant/RoHS 2-compliant |
| NRTL Programs | UL Listed CL3R, CMR, FPLR UL Listed CL3P, CMP, FPLP c(UL) Listed CMR c(UL) Listed CMP |

UL is a registered trademark of UL LLC.

PART NUMBERS AND PHYSICAL CHARACTERISTICS

| Listing | Part Number ¹ | Component Number | Application | Component Description | Insulation Colors | Component Jacket Color | Outer Jacket Color | Nominal Diameter in (mm) | Approx. Weight lbs/kft (kg/km) |
|-------------------|--------------------------|------------------|--------------|-------------------------------------|------------------------------------|------------------------|--------------------|--------------------------|--------------------------------|
| CMR/CL3R/ FPLR | AC-A1x-55 | 1 | Lock Power | 18 AWG x 4 conductors, non-shielded | Black, Red, White, Green | Purple | Green | 0.46 (11.7) | 105 (156) |
| | | 2 | Card Reader | 22 AWG x 3 twisted pairs, shielded | Black/Red, White/Green, Brown/Blue | Yellow | | | |
| | | 3 | Request Exit | 22 AWG x 4 conductors, non-shielded | Black, Red, White, Green | Red | | | |
| | | 4 | Door Contact | 22 AWG x 2 conductors, non-shielded | Black, Red | Green | | | |
| CMR/CL3R/ FPLR | AC-A2x-55 | 1 | Lock Power | 18 AWG x 4 conductors, shielded | Black, Red, White, Green | Purple | Green | 0.47 (11.9) | 110 (164) |
| | | 2 | Card Reader | 22 AWG x 3 twisted pairs, shielded | Black/Red, White/Green, Brown/Blue | Yellow | | | |
| | | 3 | Request Exit | 22 AWG x 4 conductors, shielded | Black, Red, White, Green | Red | | | |
| | | 4 | Door Contact | 22 AWG x 2 conductors, shielded | Black, Red | Green | | | |
| CMP/CL3P/ FPLP | AC-A1x-68 | 1 | Lock Power | 18 AWG x 4 conductors, non-shielded | Black, Red, White, Green | Purple | Yellow | 0.46 (11.7) | 105 (156) |
| | | 2 | Card Reader | 22 AWG x 3 twisted pairs, shielded | Black/Red, White/Green, Brown/Blue | Yellow | | | |
| | | 3 | Request Exit | 22 AWG x 4 conductors, non-shielded | Black, Red, White, Green | Red | | | |
| | | 4 | Door Contact | 22 AWG x 2 conductors, non-shielded | Black, Red | Green | | | |
| CMP/CL3P/ FPLP | AC-A2x-68 | 1 | Lock Power | 18 AWG x 4 conductors, shielded | Black, Red, White, Green | Purple | Yellow | 0.47 (11.9) | 110 (164) |
| | | 2 | Card Reader | 22 AWG x 3 twisted pairs, shielded | Black/Red, White/Green, Brown/Blue | Yellow | | | |
| | | 3 | Request Exit | 22 AWG x 4 conductors, shielded | Black, Red, White, Green | Red | | | |
| | | 4 | Door Contact | 22 AWG x 2 conductors, shielded | Black, Red | Green | | | |

PACKAGING OPTIONS

| | Wood Reel | |
|--------------------------------|-----------|------|
| | 1,000' | 500' |
| ¹ Replace "x" with: | 2 | 3 |